

Ridgeway Close, West Harptree

Guide Price £625,000

🛏 4 🍷 3 🚗 3



DETACHED HOUSE IN WEST HARPTREE - A substantial and versatile detached home, tucked away in the middle of West Harptree. All set in a good sized plot, with attractive gardens, off street parking and garage. EPC Rating D.



Key Features

- Detached four bedroom house with loft room and conservatory
- Large sitting room with feature fireplace
- Excellent eat in kitchen and separate dining room
- Four double bedrooms
- Family bathroom and two ensuite bathrooms
- Downstairs cloakroom
- Utility room and separate boot room
- Wrap around gardens with spacious decked area
- Off street parking and garage
- EPC Rating D

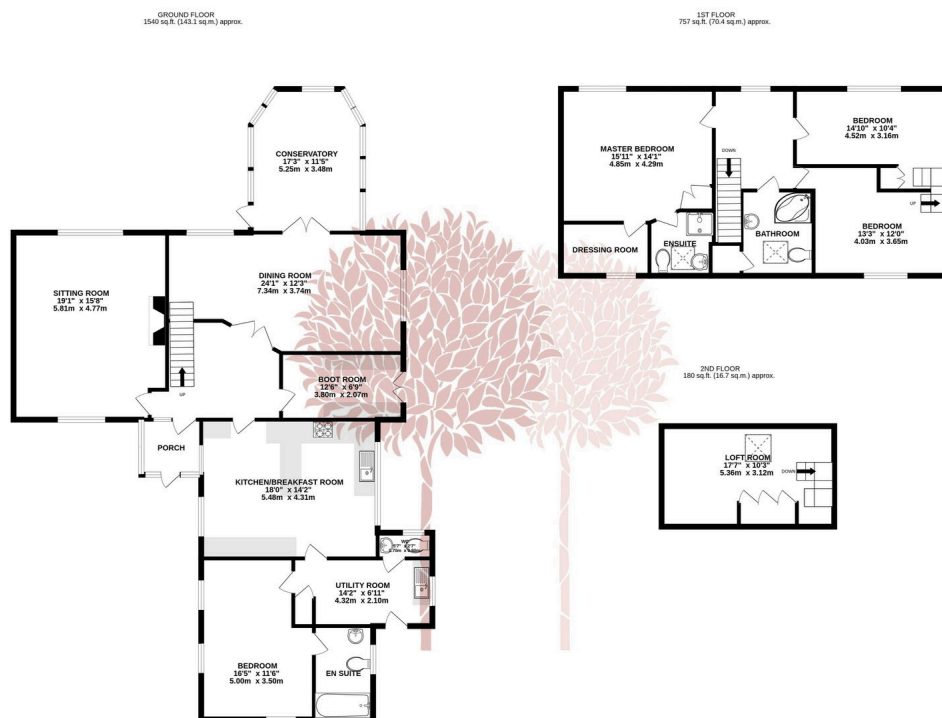

TOTAL FLOOR AREA : 2477 sq.ft. (230.1 sq.m.) approx.

Whilst every attempt has been made to ensure the accuracy of the floorplan contained here, measurements of doors, windows, rooms and any other items are approximate and no responsibility is taken for any error, omission or mis-statement. This plan is for illustrative purposes only and should be used as such by any prospective purchaser. The services, systems and appliances shown have not been tested and no guarantee as to their operability or efficiency can be given.

Made with Metropix ©2024

